

# **AGama** **NE**

**1/8 SCALE CONVERSION KIT  
FOR THE AGAMA N1**



**INSTRUCTION MANUAL**

# WELCOME!

Welcome to the N2 Conversion Kit for your Agama N1

This development to the revolutionary N1 platform expands the low CoG further, enhancing the driving performance across all racing surfaces and conditions.



# CONTENTS

INTRODUCTION.....	4
PARTS OVERVIEW.....	5
DISASSEMBLY GUIDE.....	6
FRONT ASSEMBLY.....	7
REAR ASSEMBLY.....	11



# INTRODUCTION

Thank you for purchasing this Nemo Racing and Agama product. This assembly manual contains instructions and tips for building and maintaining your new Agama N2 1/8 scale competition buggy

This conversion kit requires you to already have an Agama N1 1/8 Competition buggy. It covers the steps to determine the parts to remove prior to assembling the N2 specific parts.

The "Parts Overview" provides an overview of all of the parts contained within the Agama N2 Conversion kit. Each step will indicate which parts need to be assembled to your buggy.

Following extensive testing and feedback, we are sure you will enjoy the experience building and driving your Agama N2 1/8 Competition buggy.

## FIXINGS

FIXING	NUMBER REQUIRED
8232	4
O380	4
O300	17
SG4312	1
SG4318	6
SG4325	4
SJG4314	2
SJG4410	3
SJG4418	8
SIG4305	2
SIG4306	2
SIG4308	6
SIG4310	6
SIG4410	4



Indicates the step(s) where threadlock should be applied during assembly



Indicates the step(s) where shock or differential oil should be applied during assembly. Please refer to a relevant setup sheet for recommendations based on track conditions.



Indicates the step(s) where grease should be applied during assembly.

# PARTS OVERVIEW

PART No.	DESCRIPTION	NUMBER REQUIRED
6M6004	Front suspension mount	x 1
6M610D	Arm link stiffener	x 1
6M7701-T02	Front shock tower	x 1
6M9220	Front body mount (Carbon fiber)	x 1
6M6202L	Front shock lower bracket L	x 1
6M6202R	Front shock lower bracket R	x 1
6M7202	Front shock mount plate	x 2
6M65880	F&R shock springs (soft)(Blue)	x 4
6M65875	F&R shock springs (medium)(Green)	x 4
5N6247e4	Shock body	x 2
5N8249	Shock shaft	x 2
6M7112	Rear camber link mount	x 1
6M6005	Rear suspension mount	x 1
6M7113-T02	Rear shock tower	x 1
6M9221E	Rear body mount (Carbon fiber)	x 1
6M6603	Rear shock mount plate	x 2
6M6203	Rear shock lower bracket	x 2
6M1002	Front lower arm	x 1
6M1003	Rear lower arm	x 1
9410	1/8 scale droop screws 4*10mm	x 4
5N1207	Link for stabilizer for N2 front	x 4
5N826RS	Anti roll bar for N2 rear	x 1



# DISASSEMBLY GUIDE

**BAG A**

**STEP 1**

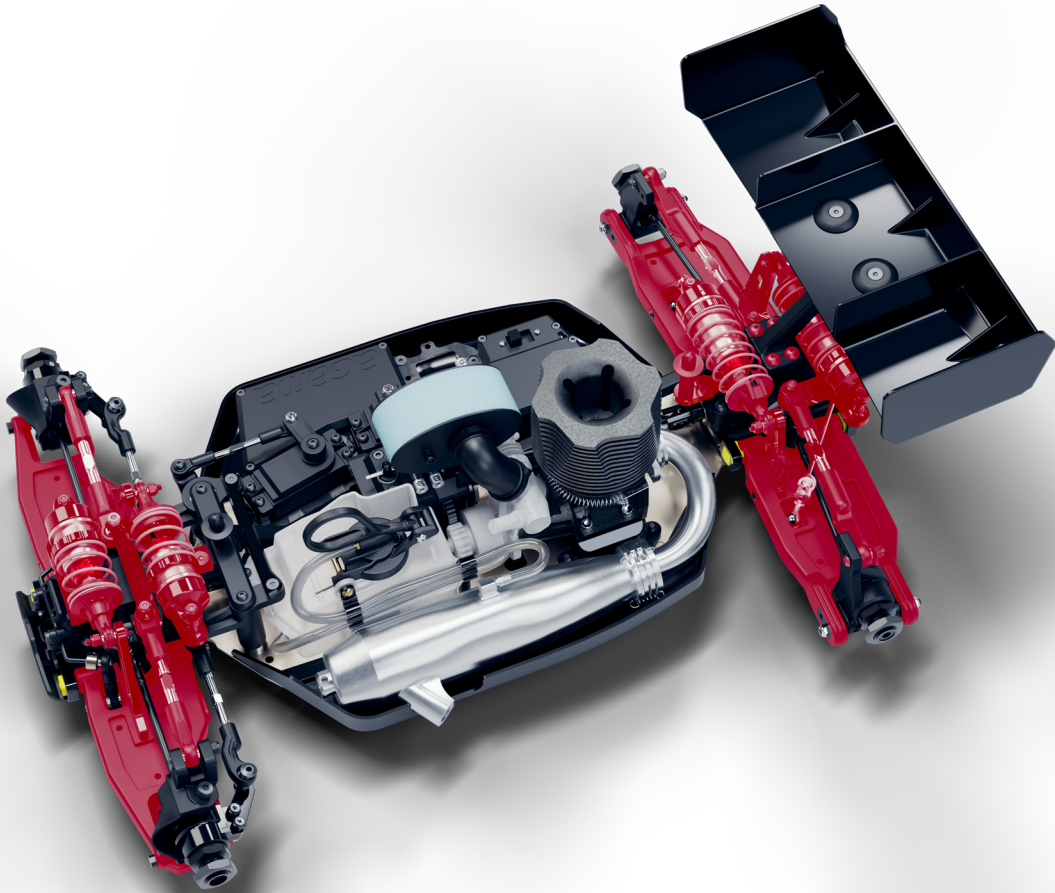

The parts highlighted in red must be removed prior to assembly of your Agama N2 Conversion kit.

The front shocks and Front/Rear turnbuckles will be used in the assembly of the N2, but must be removed from the vehicle to enable simple building.

# BAG FRONT

# STEP 1

6M1002

The front arms from the N1 (5N1002) are replaced with 6M1002. These feature additional mounting holes for the N2 suspension lower brackets.

5N1207 (x4)

Replace the link stabiliser plastic (1207) with 5N1207 to ensure smooth clearance for the N2 shock geometry.

6M1002

# BAG FRONT

# STEP 2

SJG4308

SJG4410 (x3)

6M9220

1

# BAG FRONT

# STEP 3

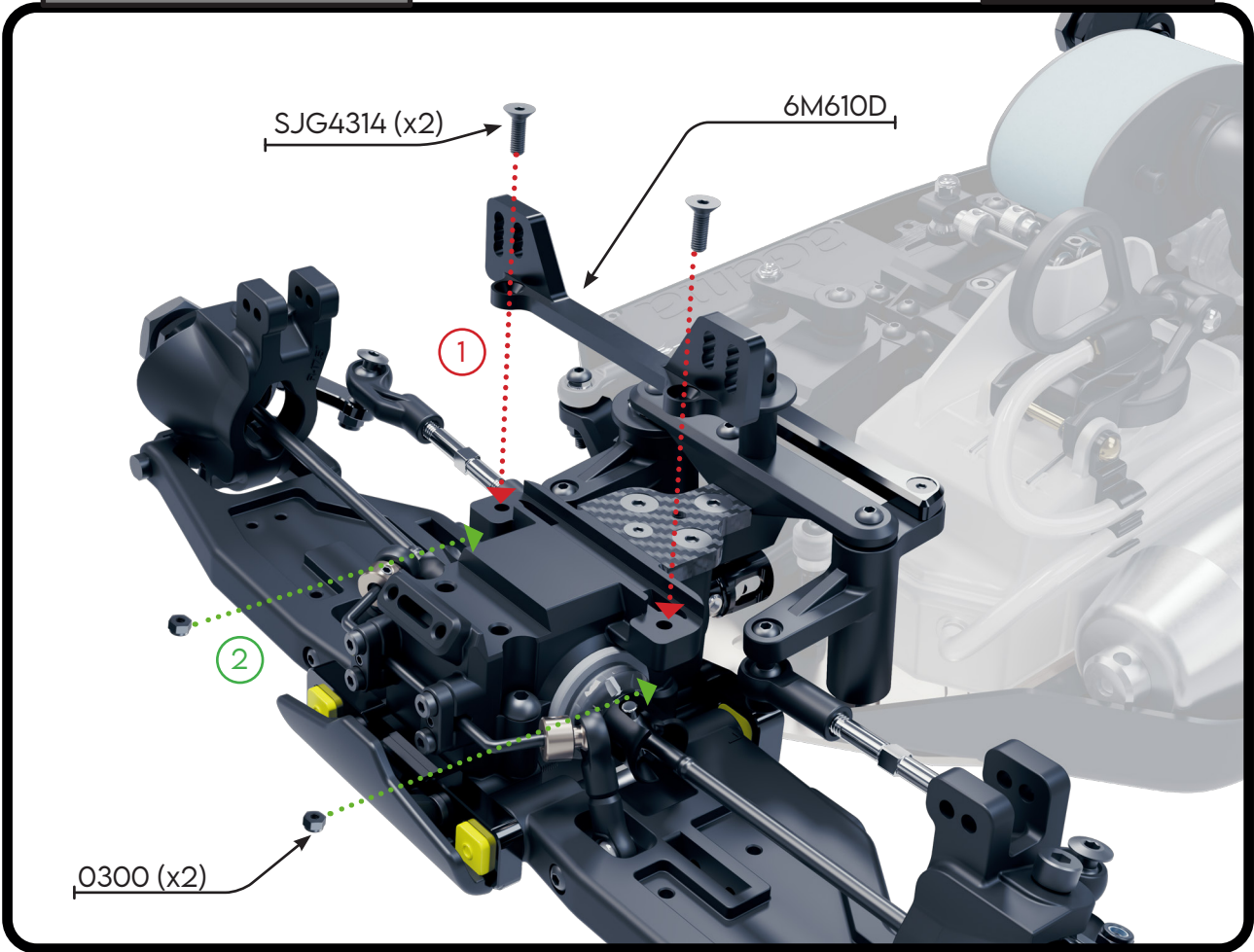

# BAG FRONT

# STEP 4

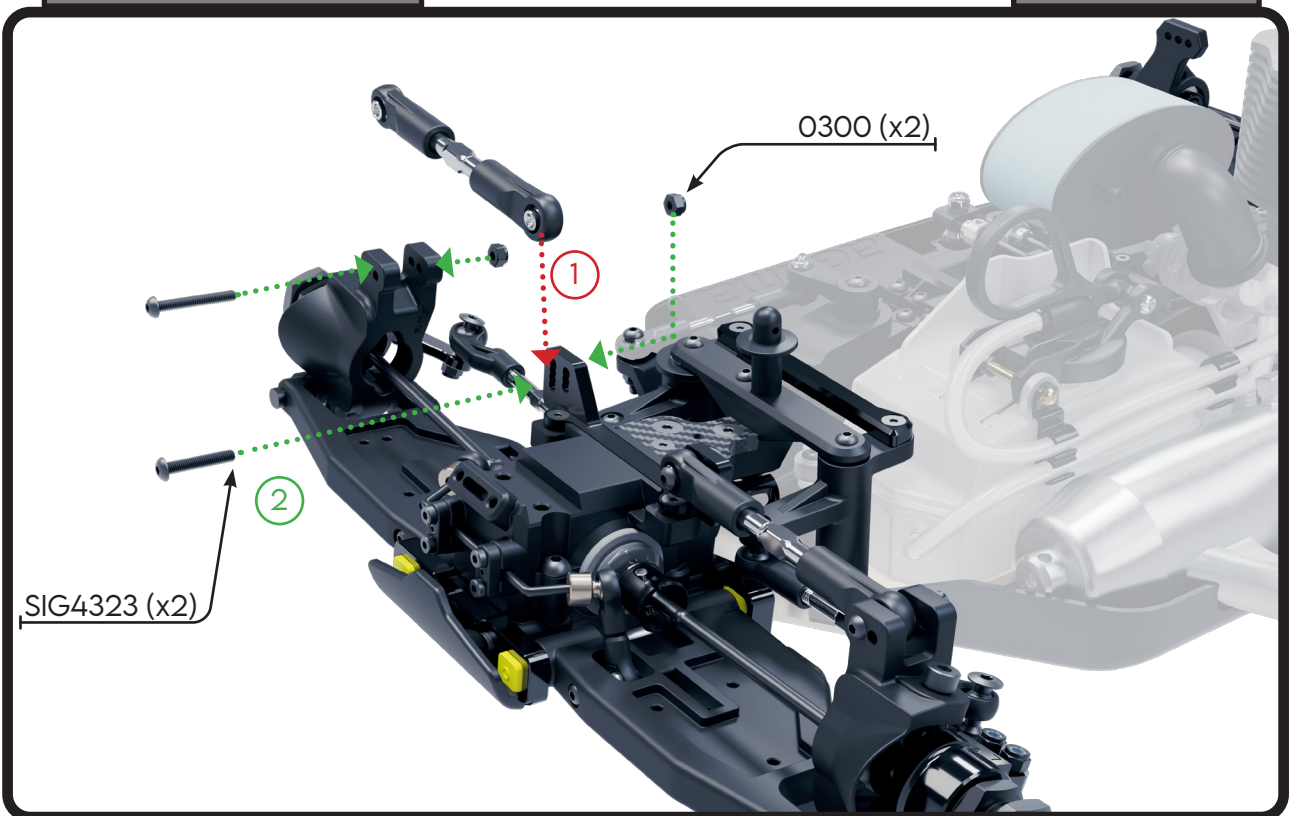

# BAG FRONT

# STEP 5

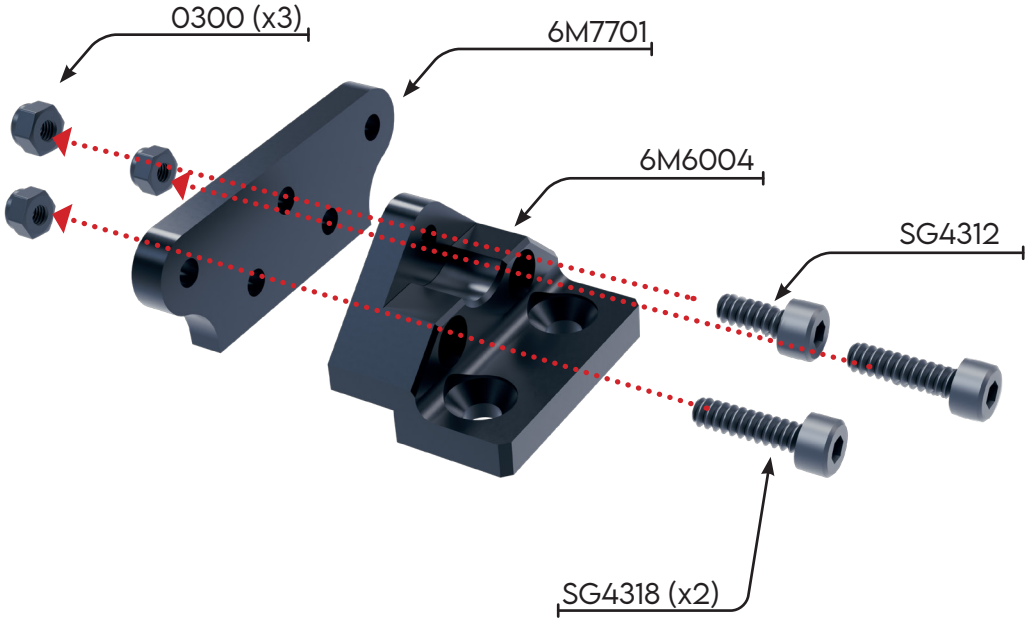

# BAG FRONT

# STEP 6

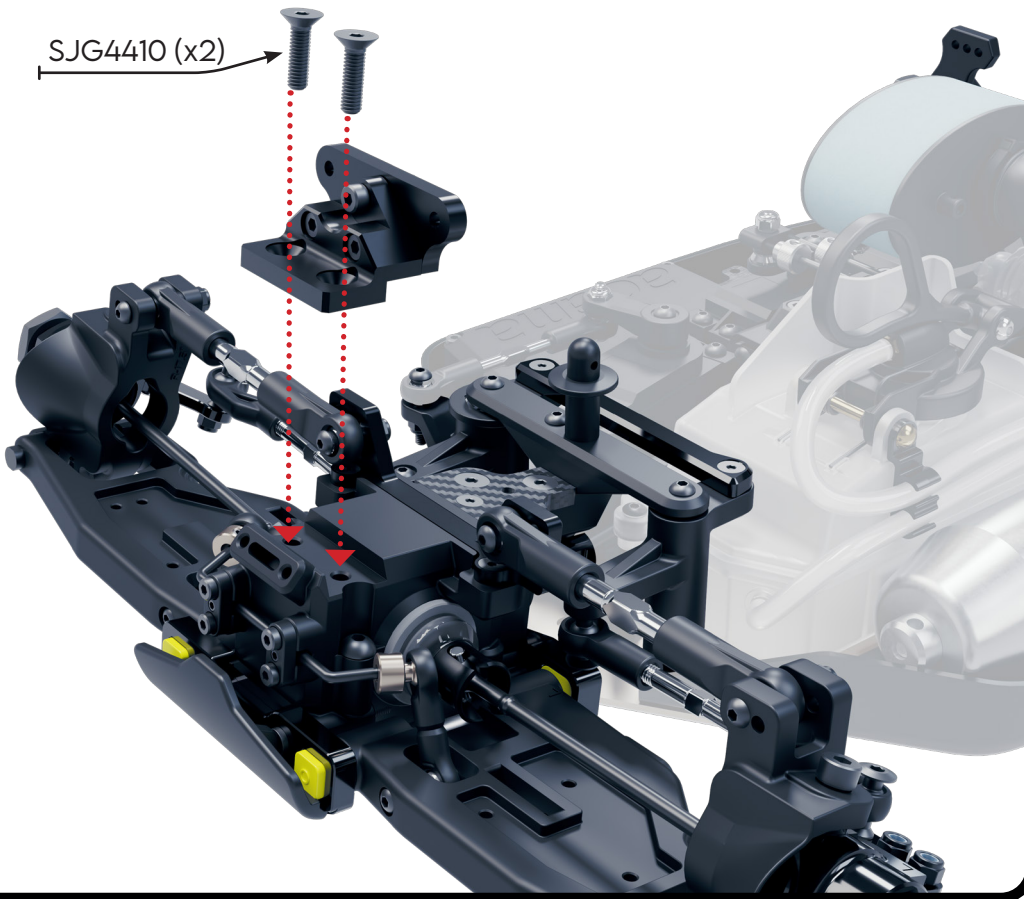

# BAG FRONT

# STEP 7

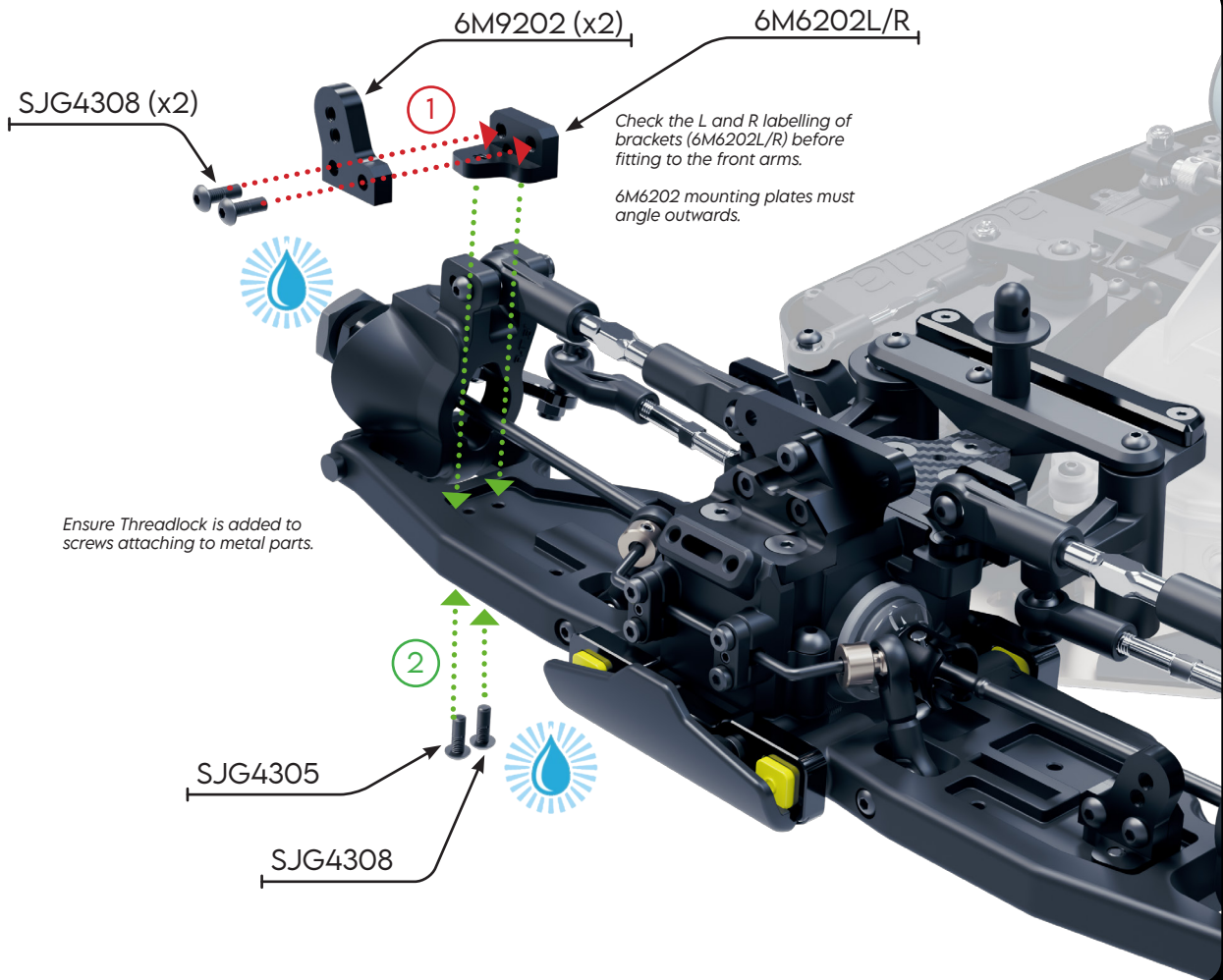

# BAG FRONT

# STEP 8

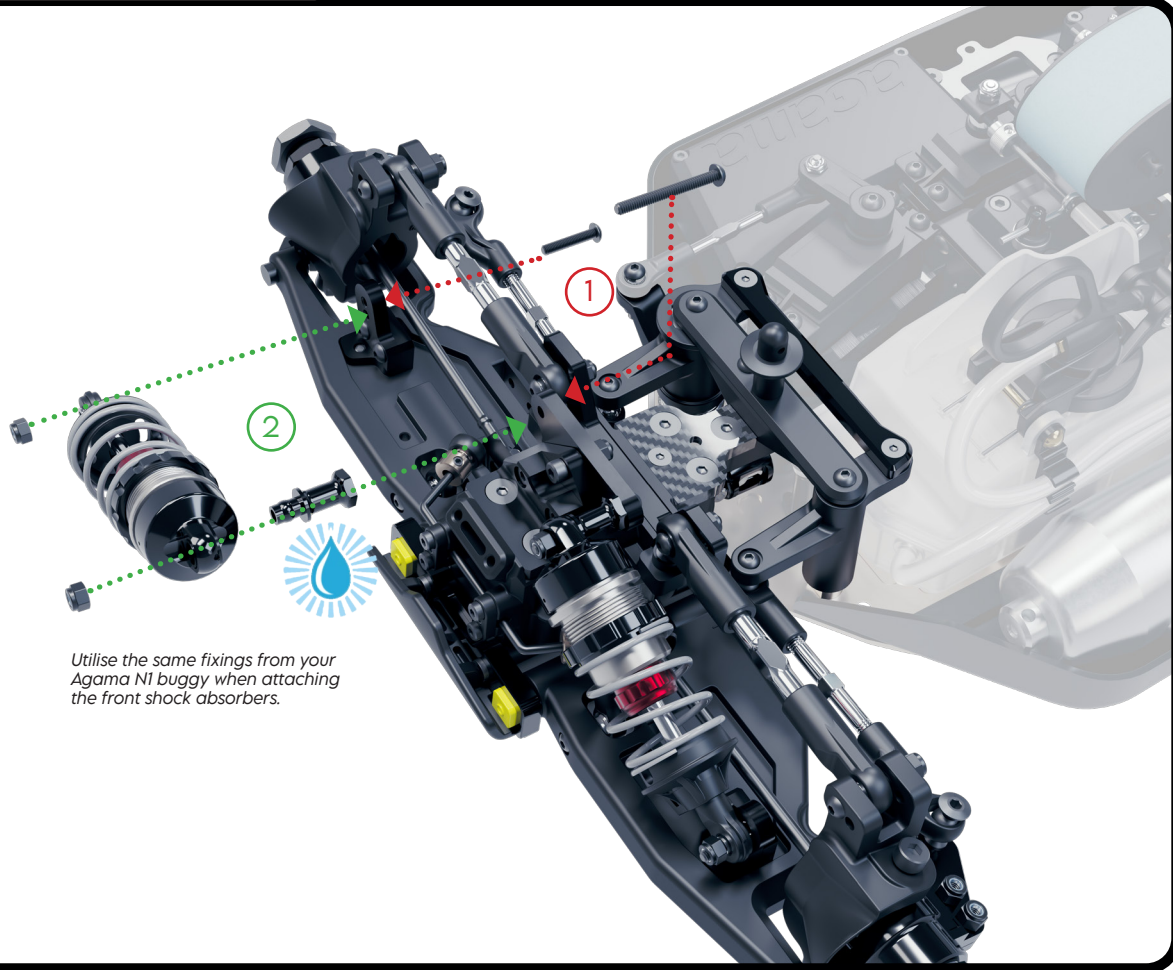

# BAG FRONT

# STEP 9

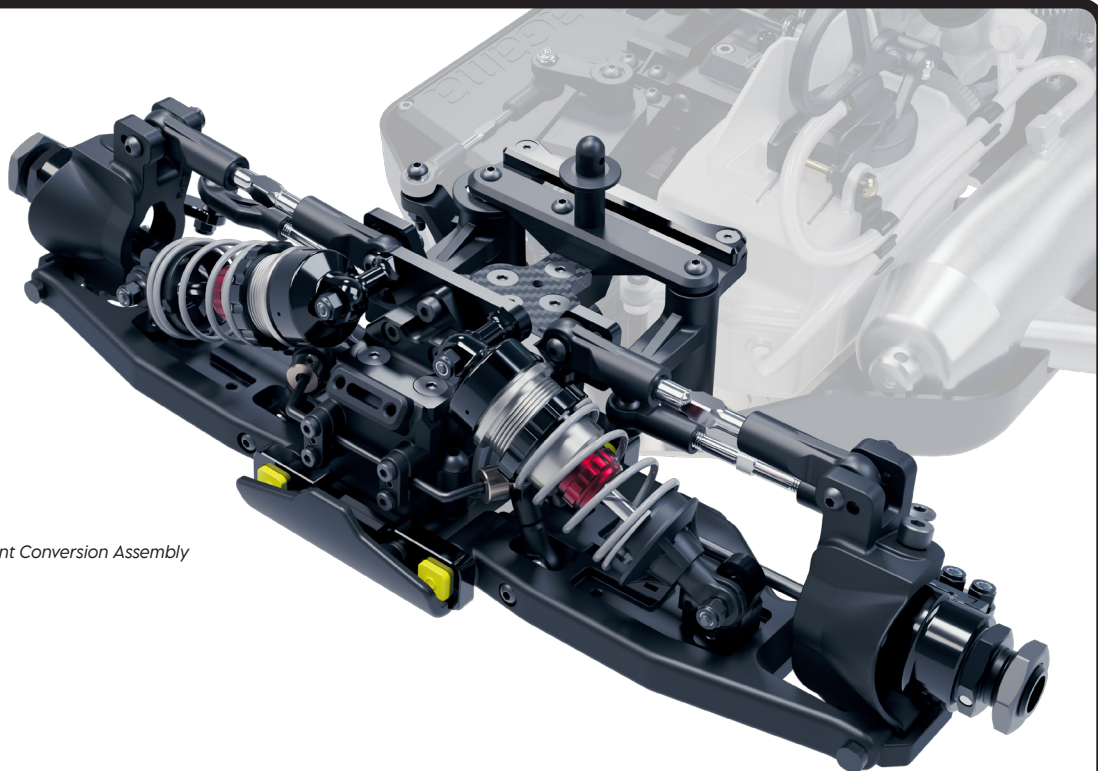

# BAG REAR

# STEP 1

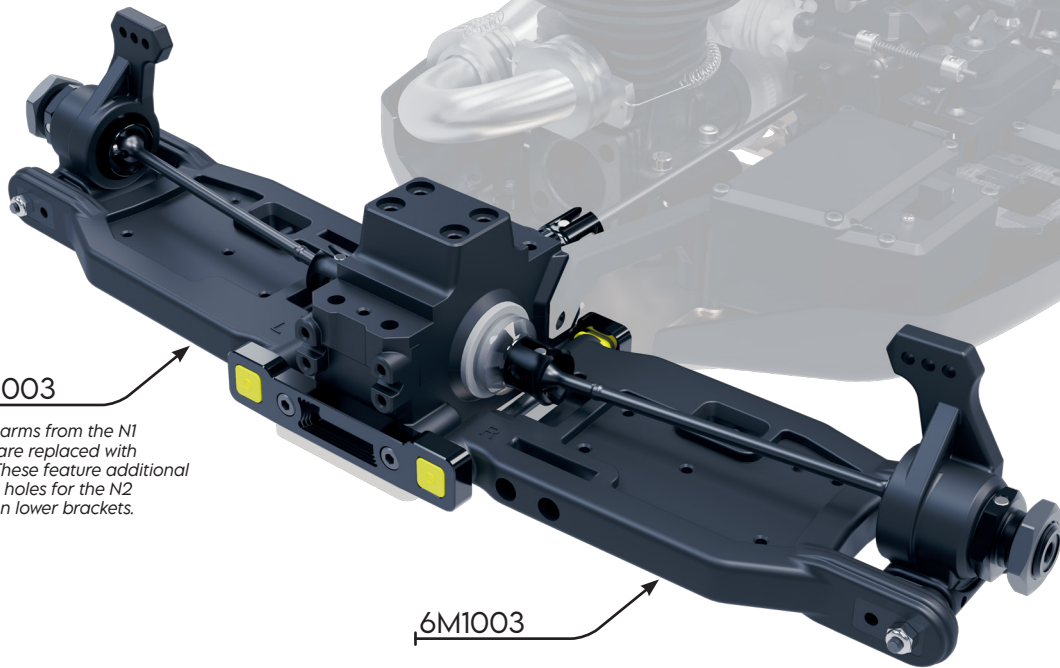

# BAG REAR

# STEP 2

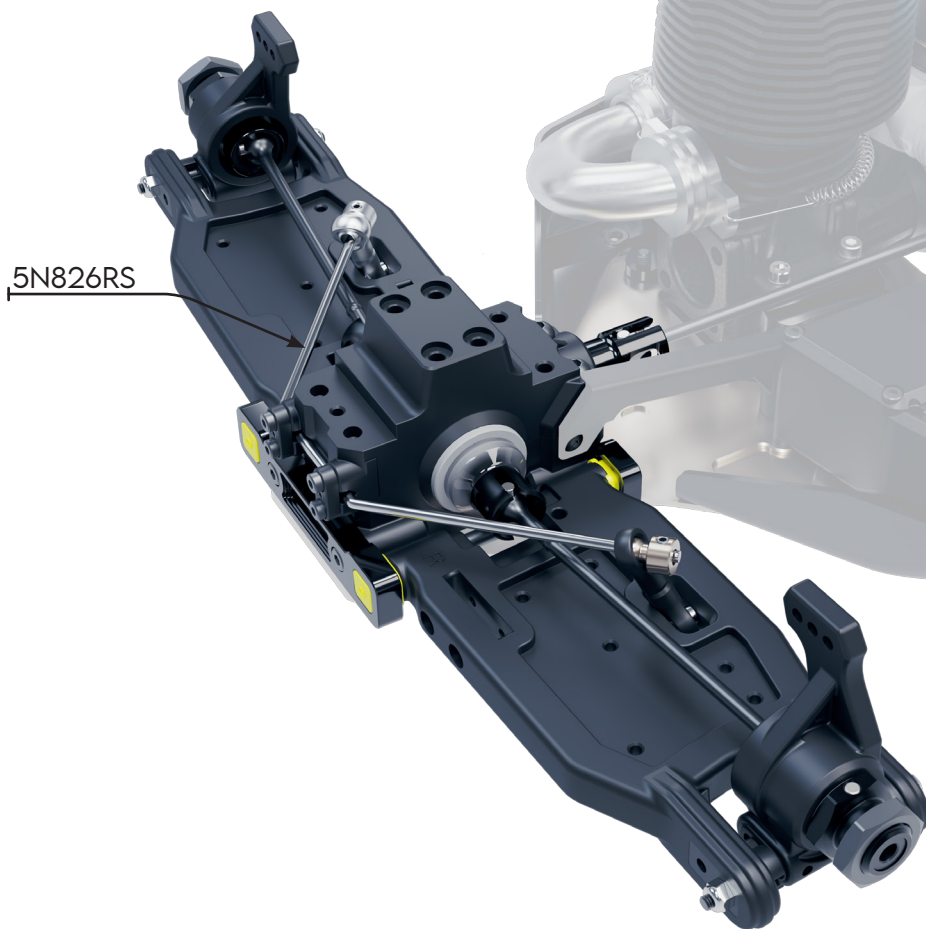

# BAG REAR

# STEP 3

SJG4310 (x2)

6M9221E (x2)

Utilise the body post and fixing from your Agama N1 buggy

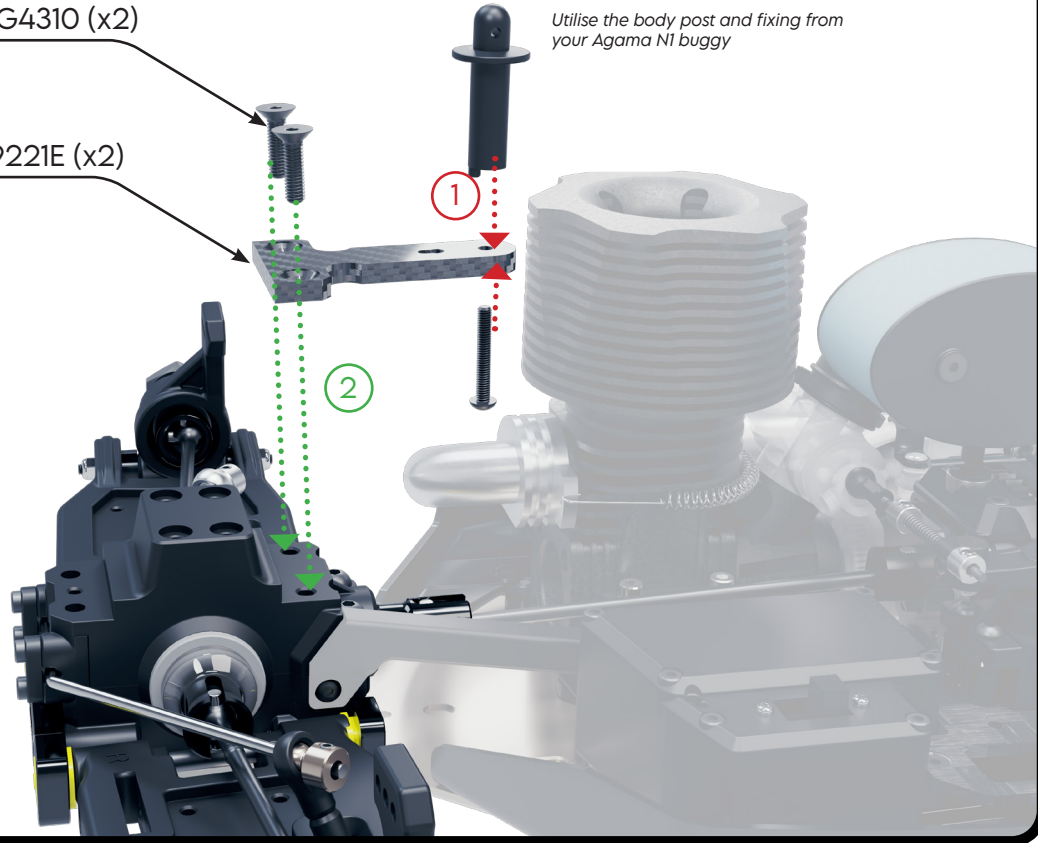

# BAG REAR

# STEP 4

6M6603

6M6203

6M6203 mounting plates must angle outwards.

Ensure Threadlock is added to screws attaching to metal parts.

SIG4308

SIG4306

SIG4310

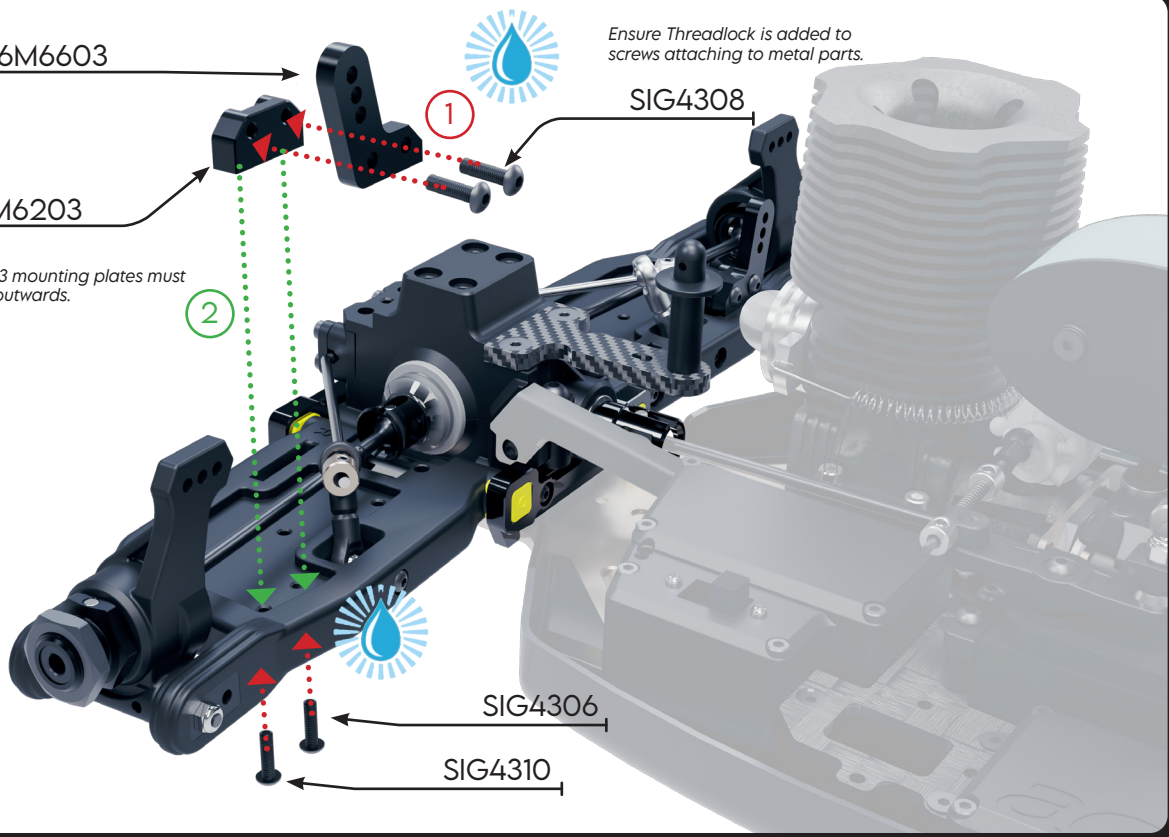

# BAG REAR

# STEP 5

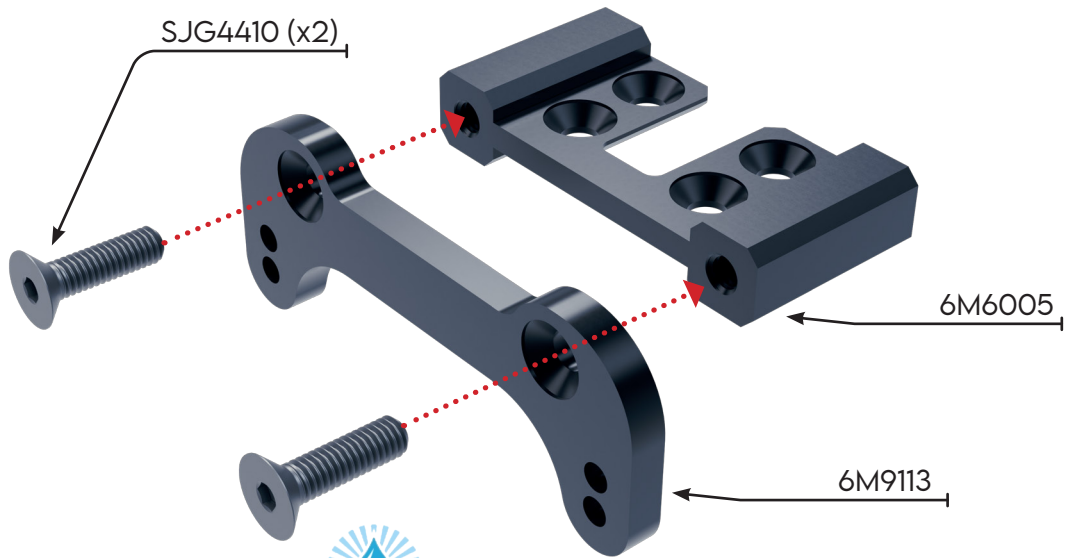

Ensure Threadlock is added to screws attaching to metal parts.



# BAG REAR

# STEP 6

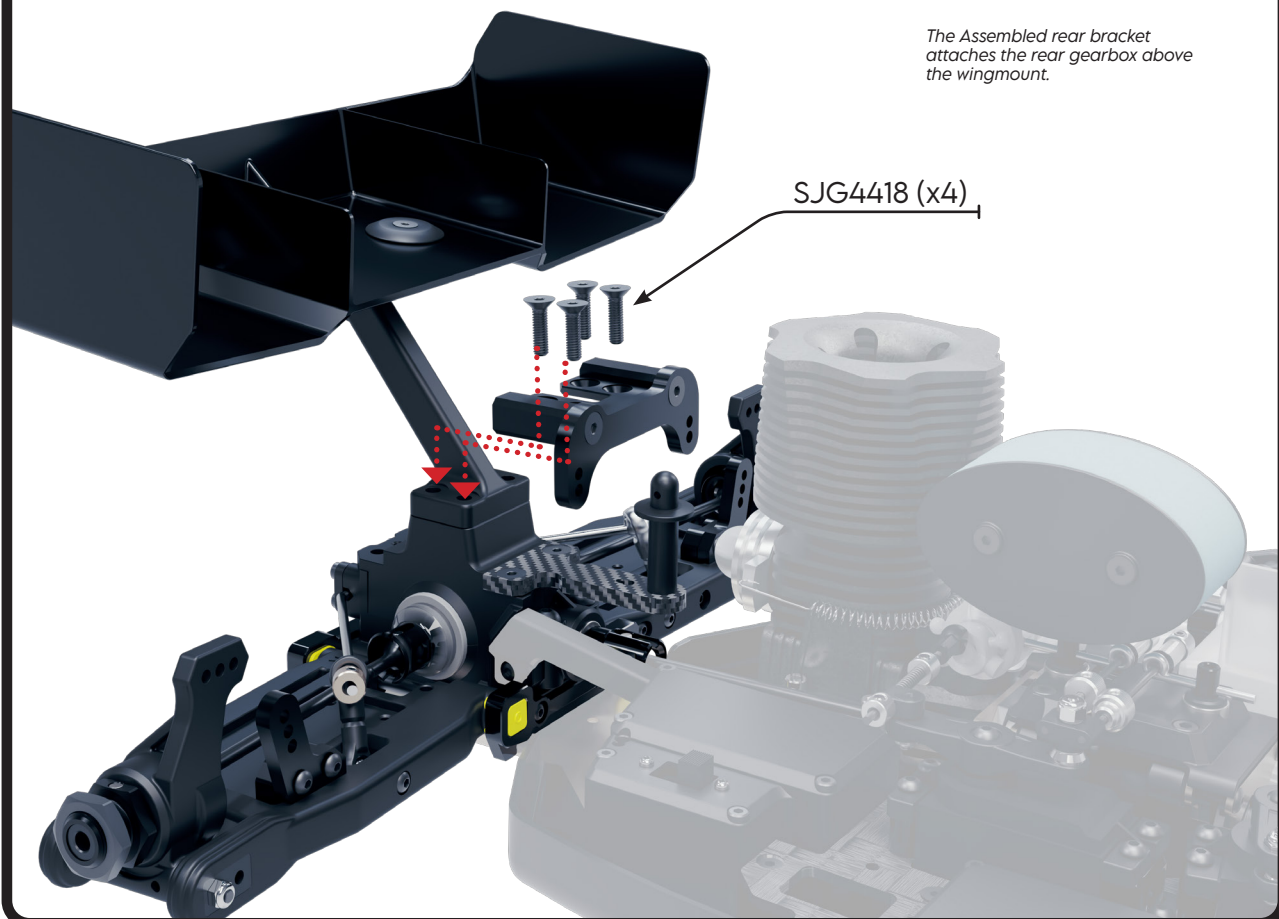

The Assembled rear bracket attaches the rear gearbox above the wingmount.

# BAG REAR

# STEP 7

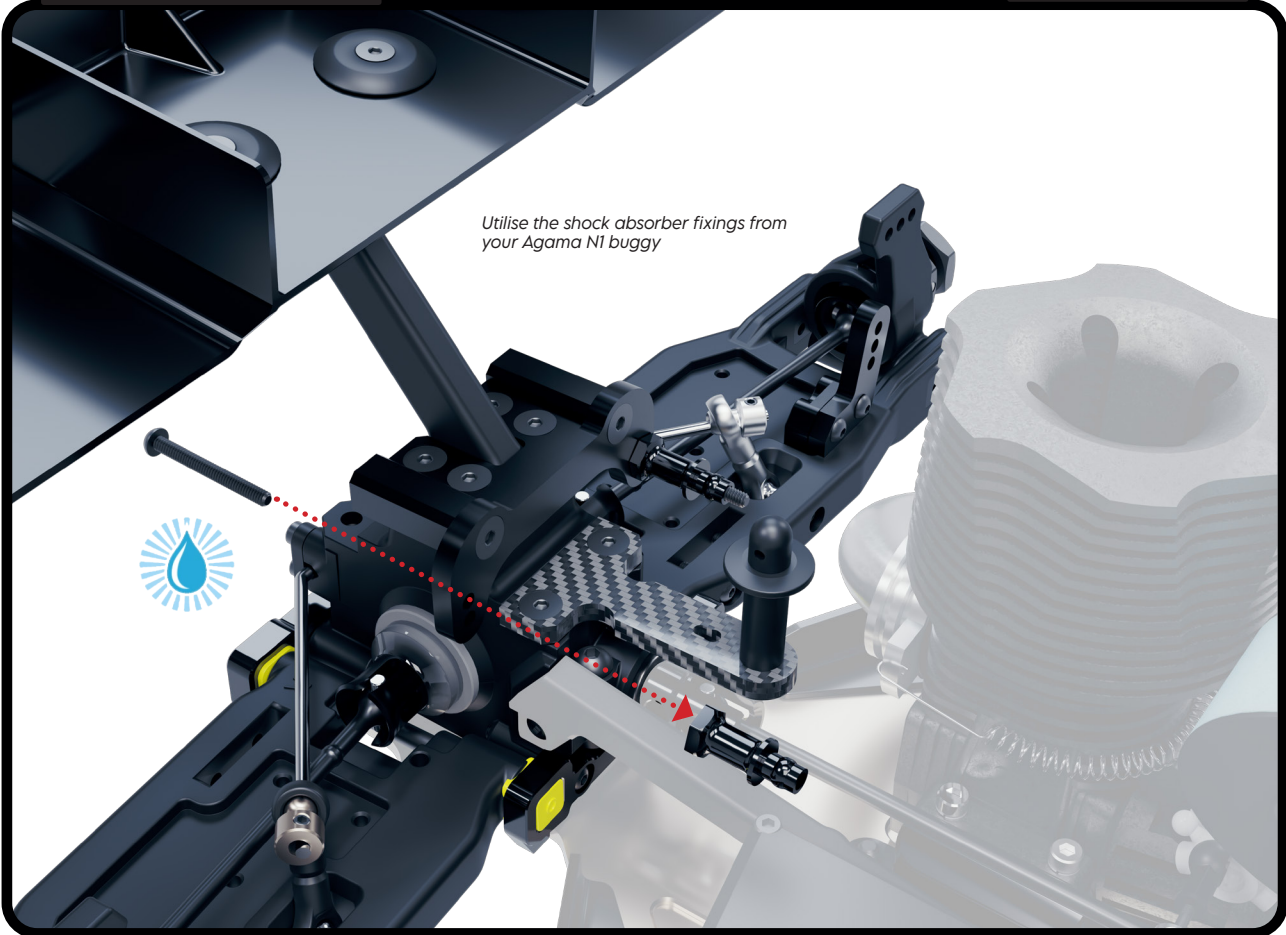

# BAG REAR

# STEP 8

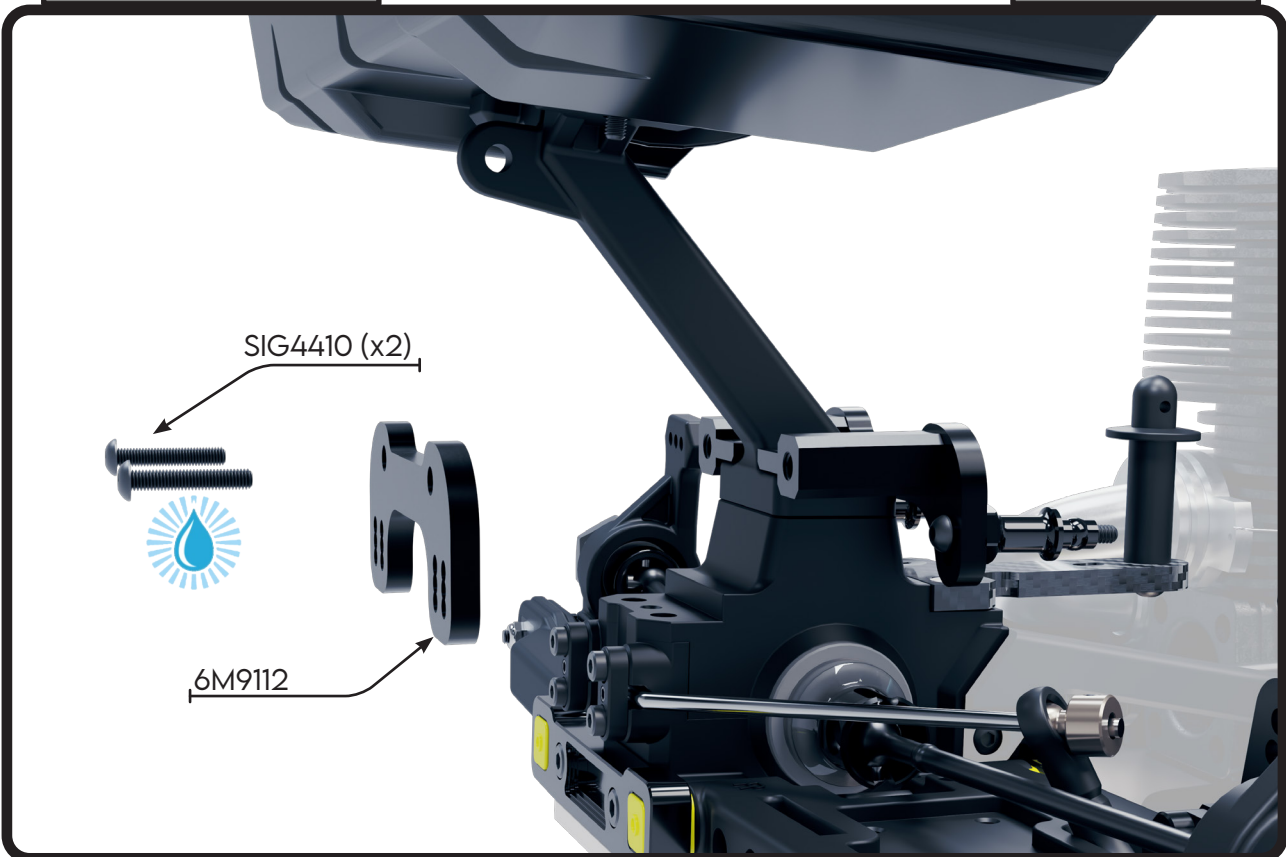

## BAG REAR

## STEP 9

Utilise the shock absorber fixings from your Agama N1 buggy.

Ensure that you replace the shock bodies and shock shafts on the rear shocks with the new parts supplied in the N2 Conversion kit (5N6247e4 and 5N8249). We recommend Beta 50wt oil as a setup starting point.

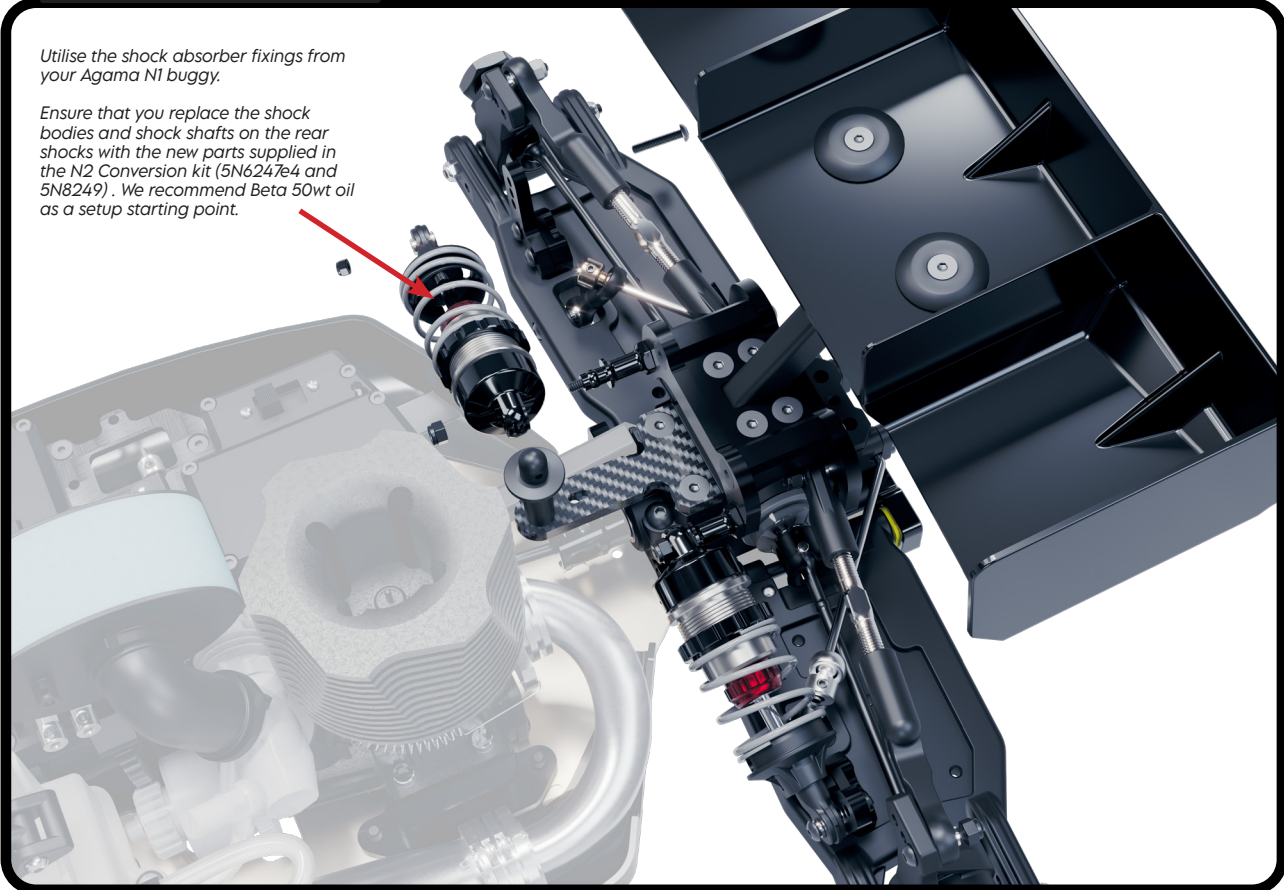

## BAG REAR

## STEP 10

Completed Rear Conversion Assembly

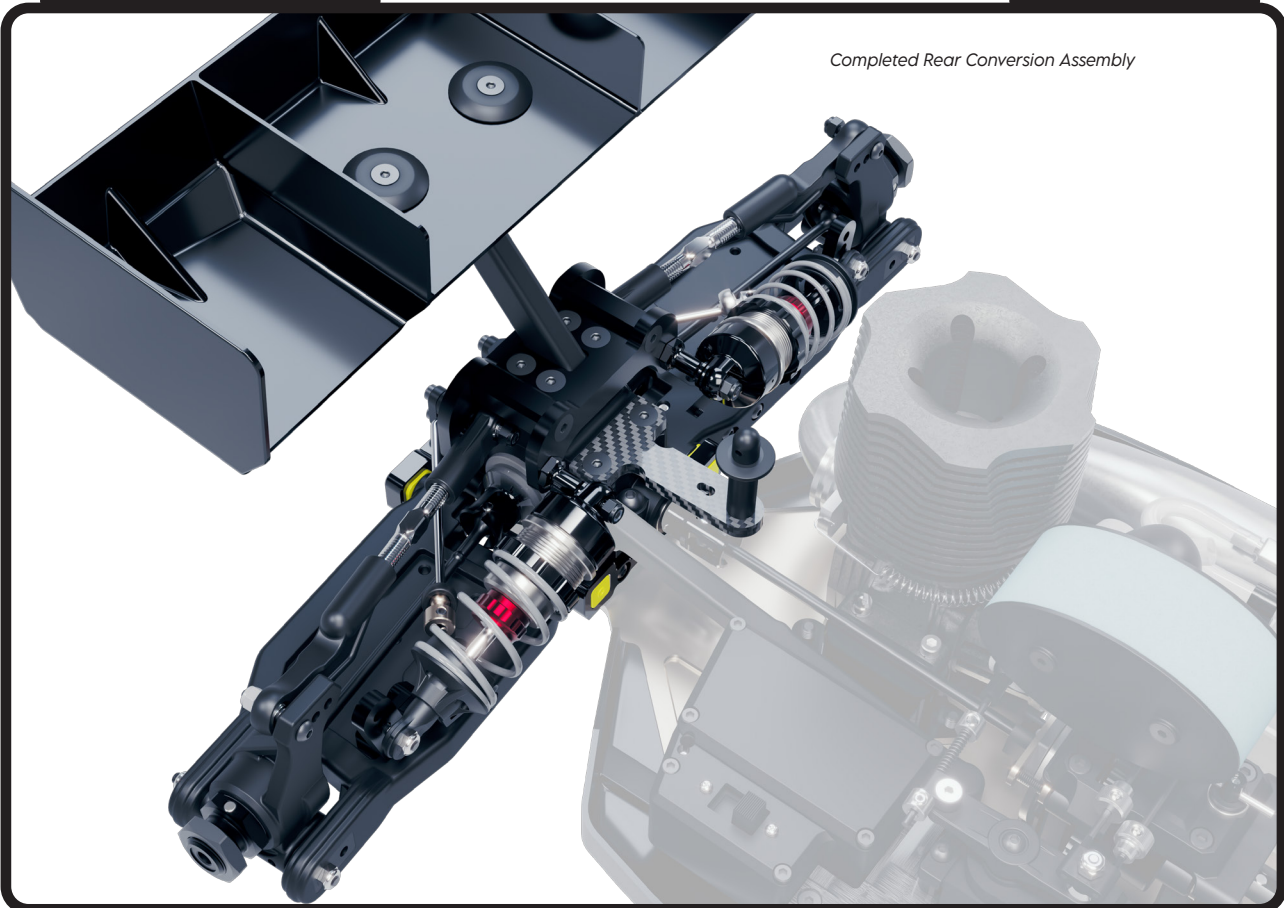

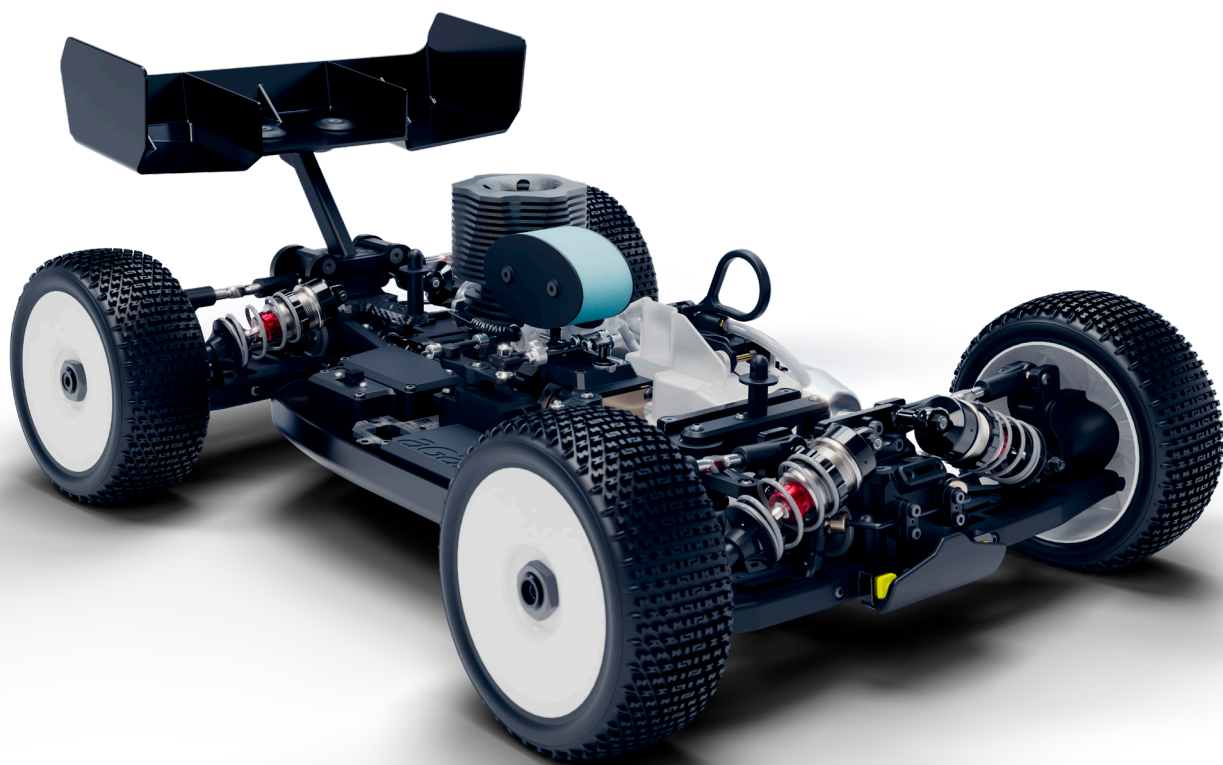



**NEMO RACING**